



FOR SUBLEASE! • 10,000 SF



WAITE PARK INDUSTRIAL

2330 County Road 137 | Waite Park, MN 56387

Industrial warehouse/office in West St. Cloud location sublease available now

- Prime location in 54,320 SF industrial multi-tenant building on 5.54 acres
- Under 4 years left on lease; negotiable terms
- Up to 22' clear height, 50' column spacing, 3 phase power, heat/AC
- 9,770 SF industrial, 768 SF office, and restroom
- Internal docking area with two docks, potential for future drive-ins
- Signage and ample parking
- 2 miles from I-94 and less than mile from Hwys 23 and 15

Net Rent: \$5.75 PSF • **CAM & Taxes:** \$2.59 PSF

Brian Potratz
612-269-7401

[**brian@CEGspaces.com**](mailto:brian@CEGspaces.com)

Jeff Salzbrun
612-428-3333

[**jeff@CEGspaces.com**](mailto:jeff@CEGspaces.com)

Nicole Langer
612-554-6208

[**nicole@cegspaces.com**](mailto:nicole@cegspaces.com)

[**CEGspaces.com/waite-park**](https://www.CEGspaces.com/waite-park)

[**GO TO MAP**](#)

Commercial Equities Group
— Investment Real Estate Services

Great Location • Outdoor Storage



2 miles from Love's Travel Stop



Additional Opportunity

- 2+ acres of gated outdoor storage for trucks, equipment, lumber, etc.
- Separate lease from indoor spaces and sublease



Bay B Office + Warehouse

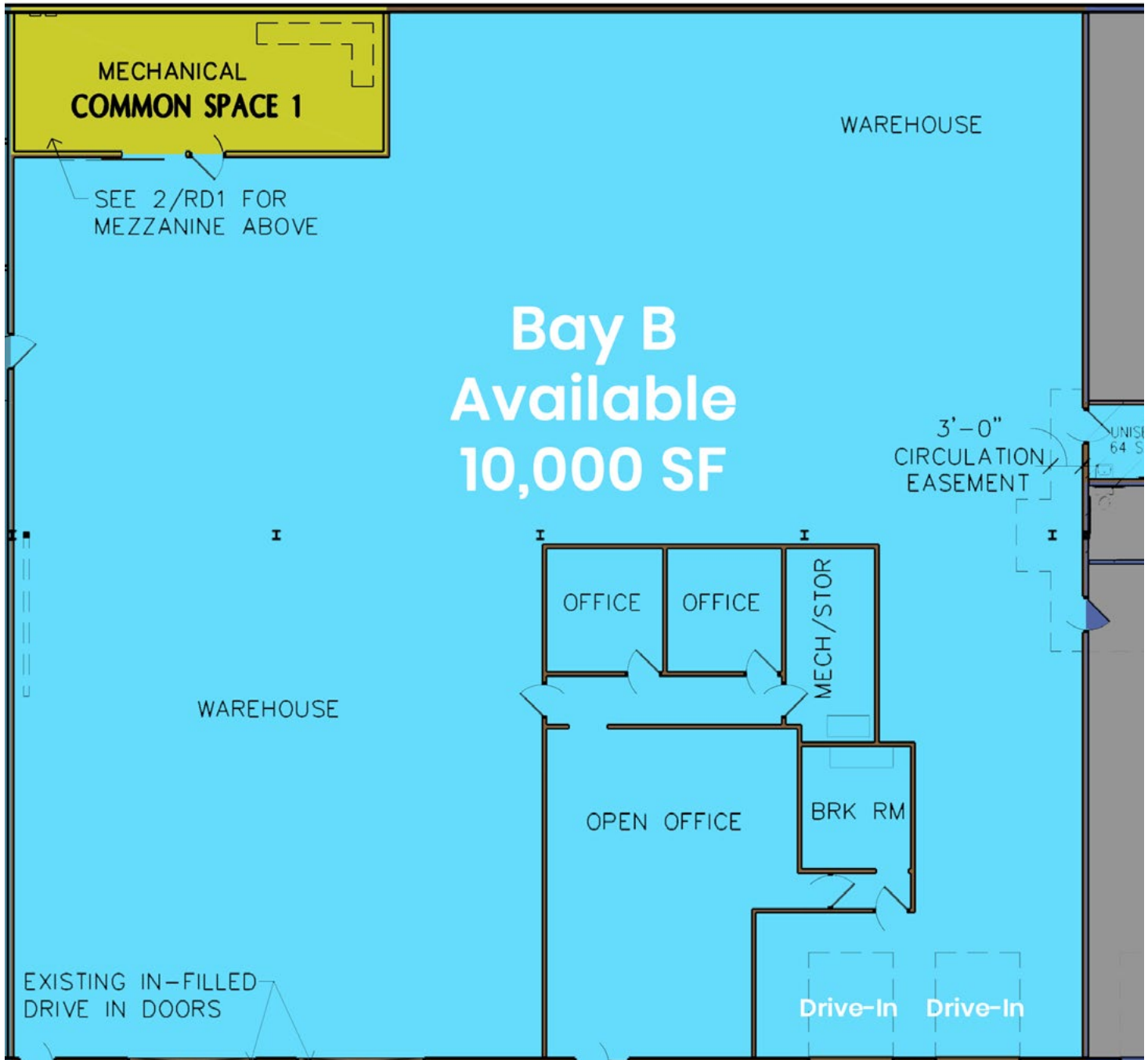

Commercial Equities Group
Investment Real Estate Services

WAITE PARK • 10,000 SF SUBLEASE

2330 County Road 137 | Waite Park, MN 56387

Brian Potratz | 612-269-7401 | brian@CEGspaces.com

Negotiable Terms

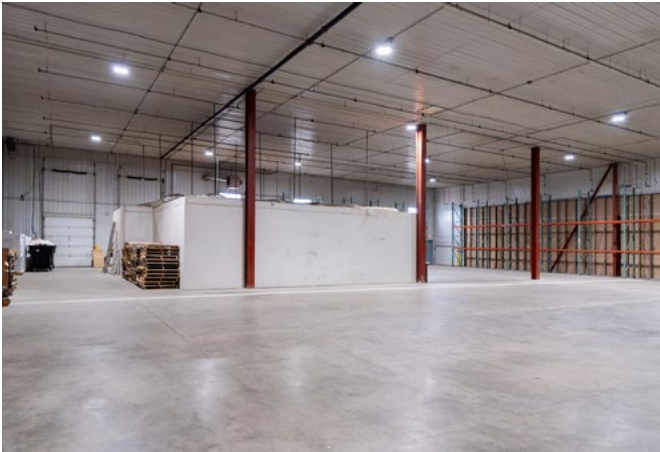

Commercial Equities Group
— Investment Real Estate Services

WAITE PARK • 10,000 SF SUBLEASE
2330 County Road 137 | Waite Park, MN 56387
Brian Potratz | 612-269-7401 | brian@CEGspaces.com